



integrate  
by doma

# Sensory Guide for the David Owsley Museum of Art

Integrate is an accessibility app created to serve as a tool to make the David Owsley Museum of Art more accessible to those with learning disabilities, including cognitive disabilities, ADHD, and TBI. The objective is to expand on the educational aspect of DOMA by increasing the learning potential and programs to be more accessible to everyone, including those who need a wider range of learning capabilities.

The David Owsley Museum of Art is dedicated to providing the best experience possible to each visitor. To better compensate our visitors, we have provided a sensory guide within our app, Integrate, as well as at the entrance of each gallery.

A sensory guide creates awareness of each space and gallery within the museum during or prior to people's visit. This tool serves as a reference to prepare our visitors for the conditions of each gallery within the David Owsley Museum of Art.

# Spaces with natural or bright lighting

## Lower Level *(Second Floor)*

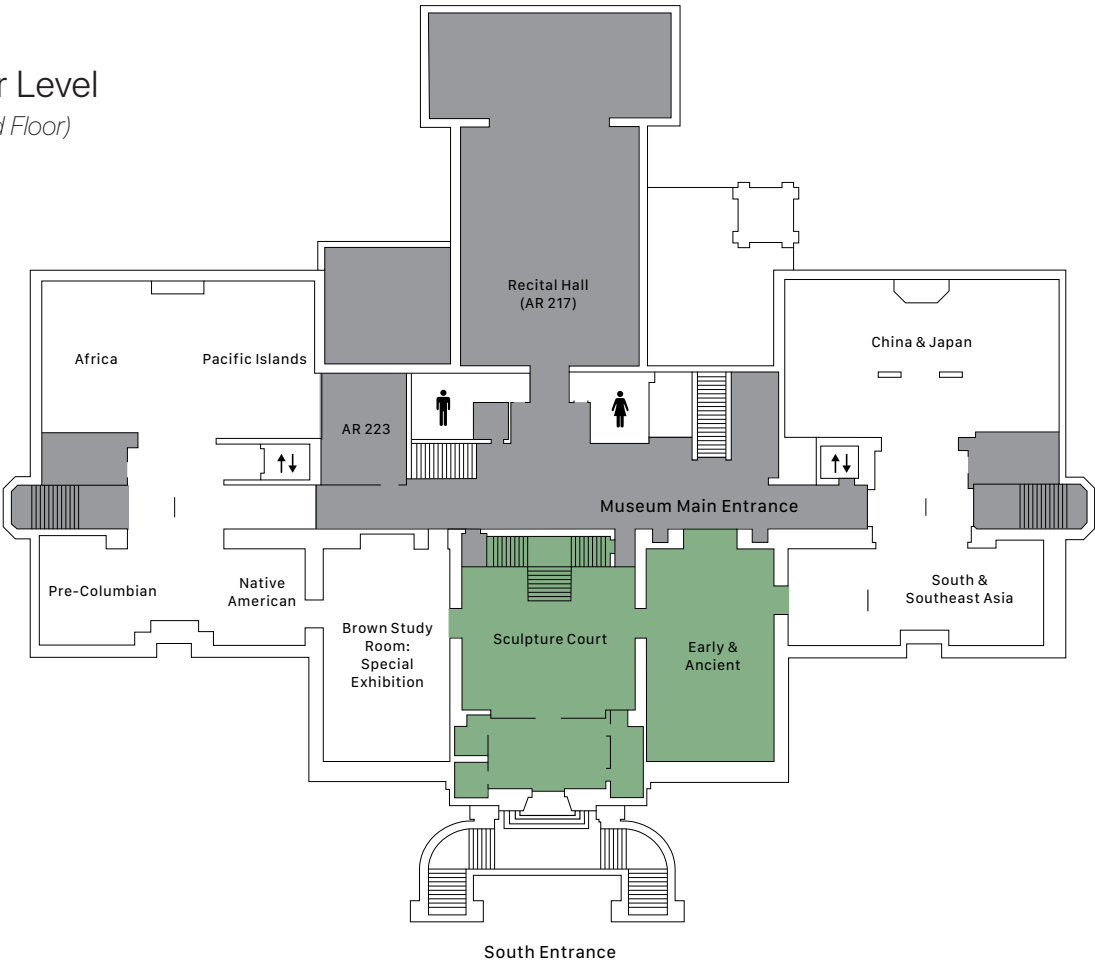

## Upper Level *(Third Floor)*

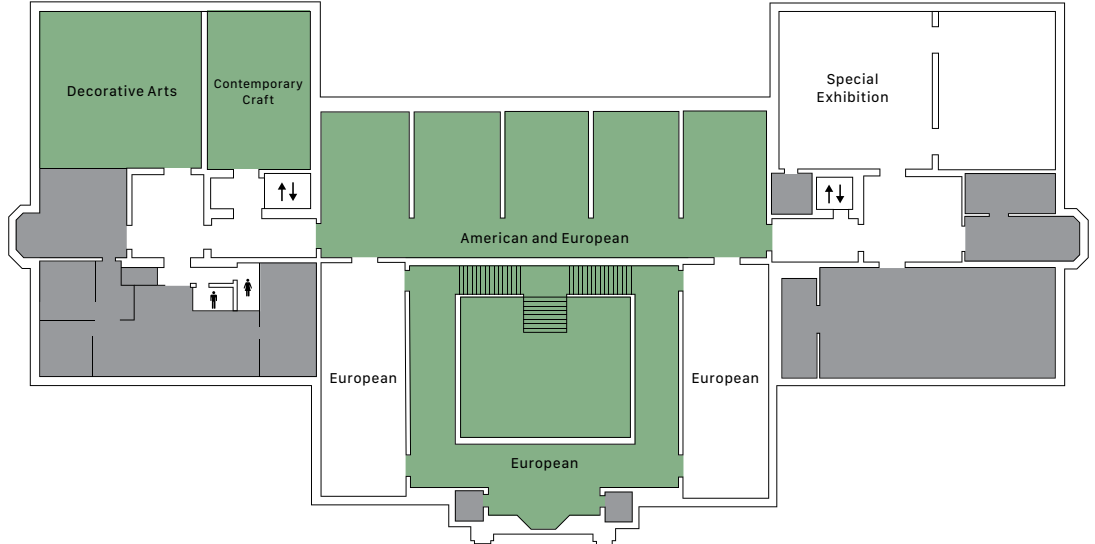

# Spaces with subdued lighting

Lower Level  
*(Second Floor)*

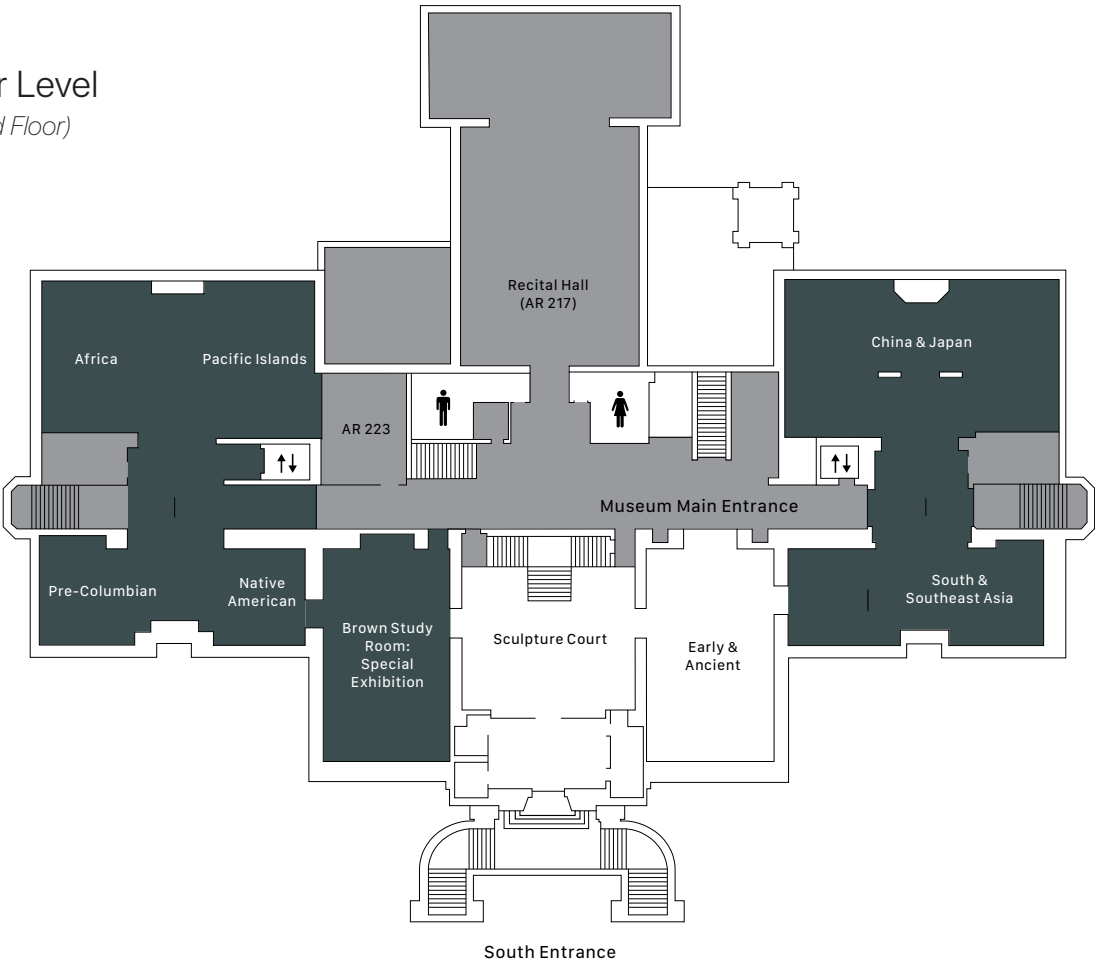

Upper Level  
*(Third Floor)*

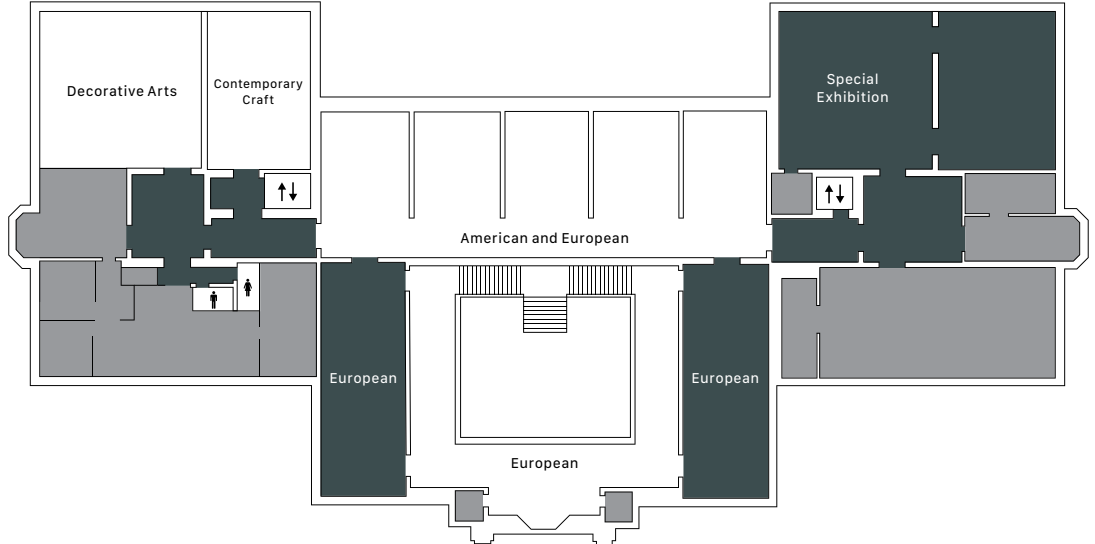

# Spaces that can be loud

## Lower Level (Second Floor)

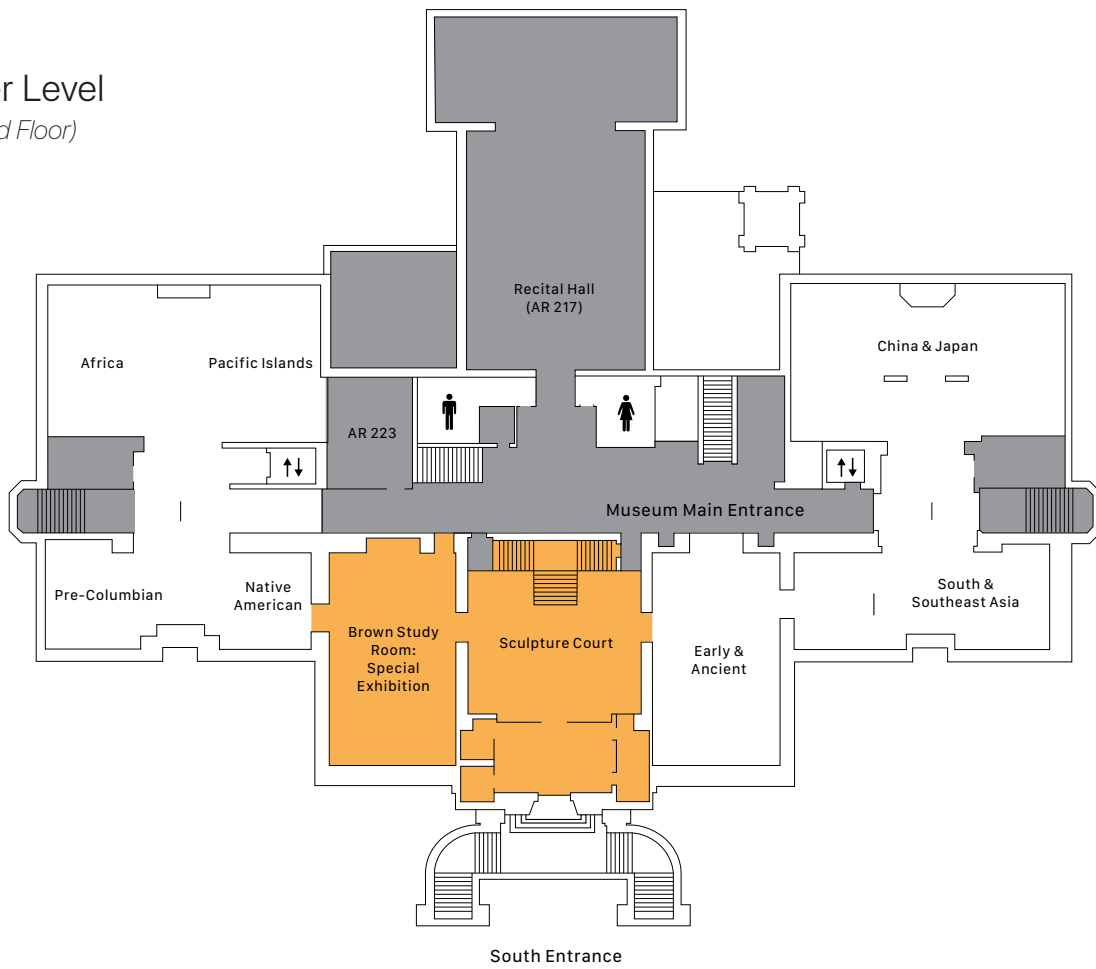

## Upper Level (Third Floor)

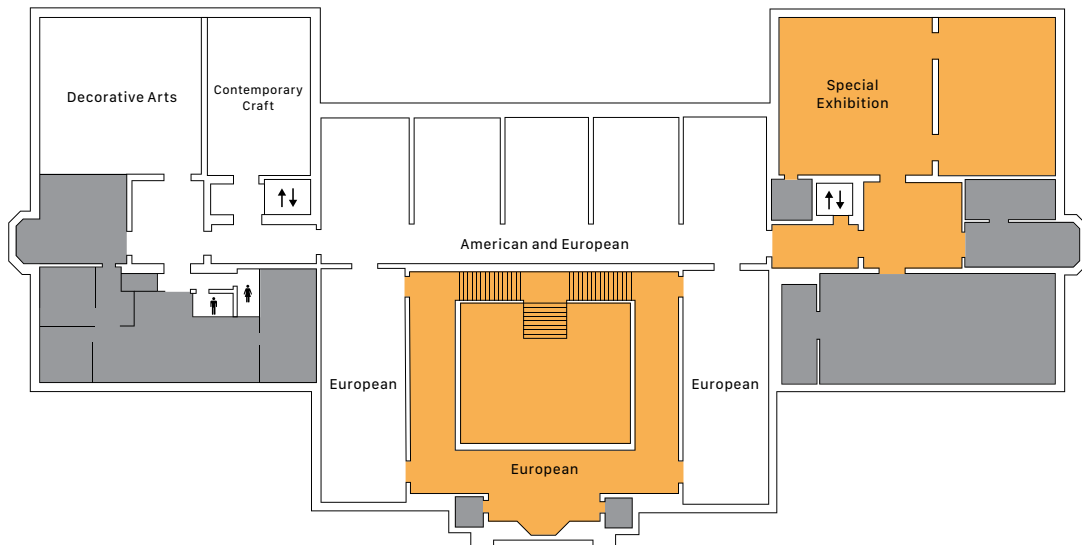

# Spaces that tend to be quiet

## Lower Level (Second Floor)

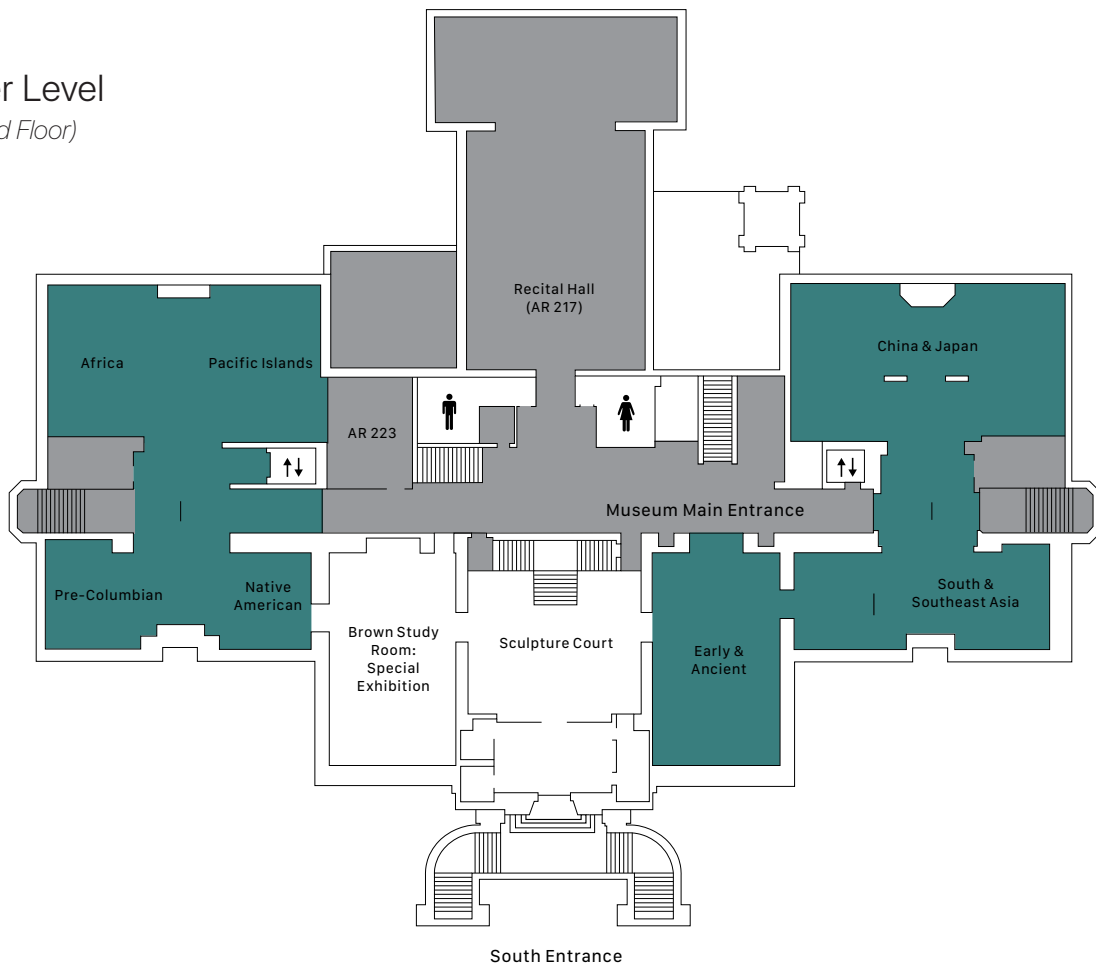

## Upper Level (Third Floor)

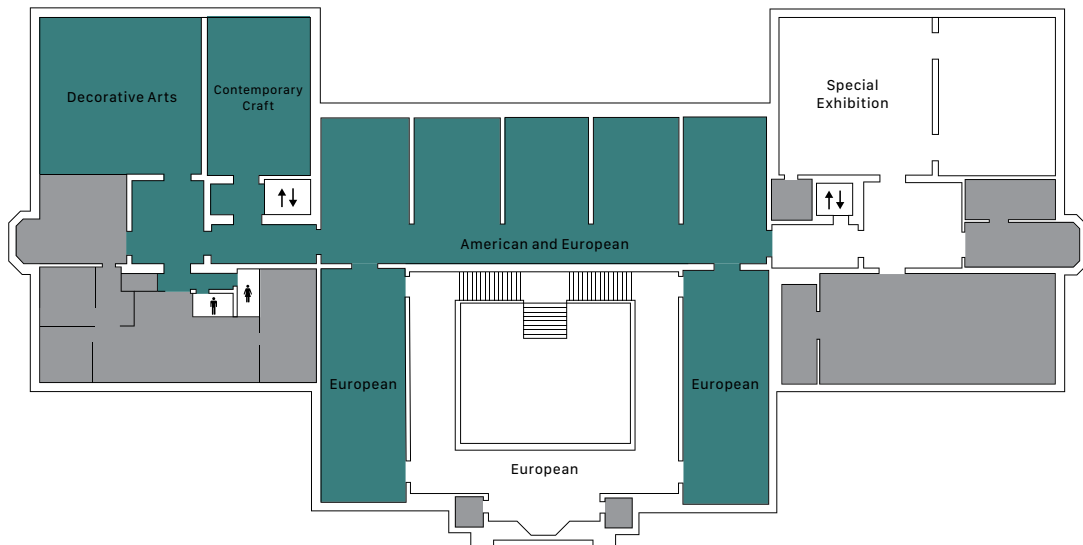

# Spaces that can be crowded

## Lower Level (Second Floor)

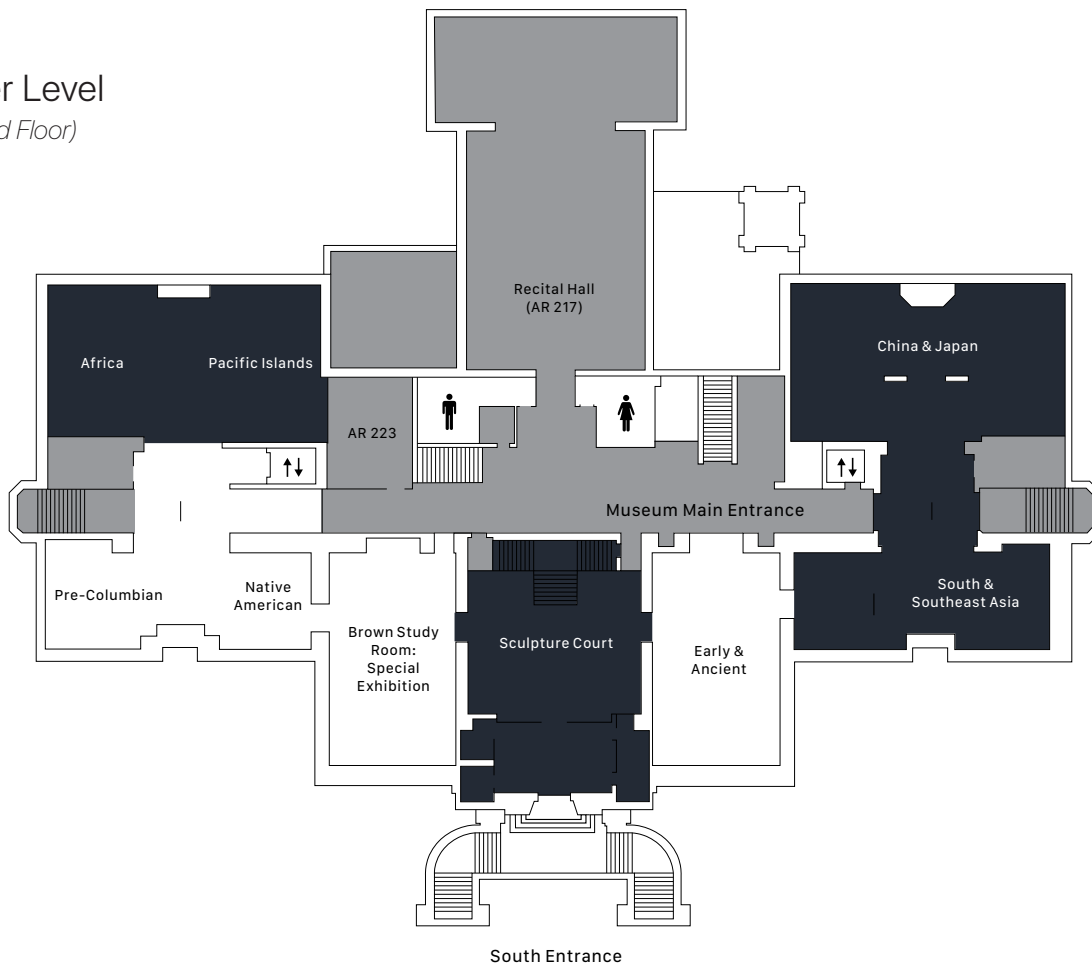

## Upper Level (Third Floor)

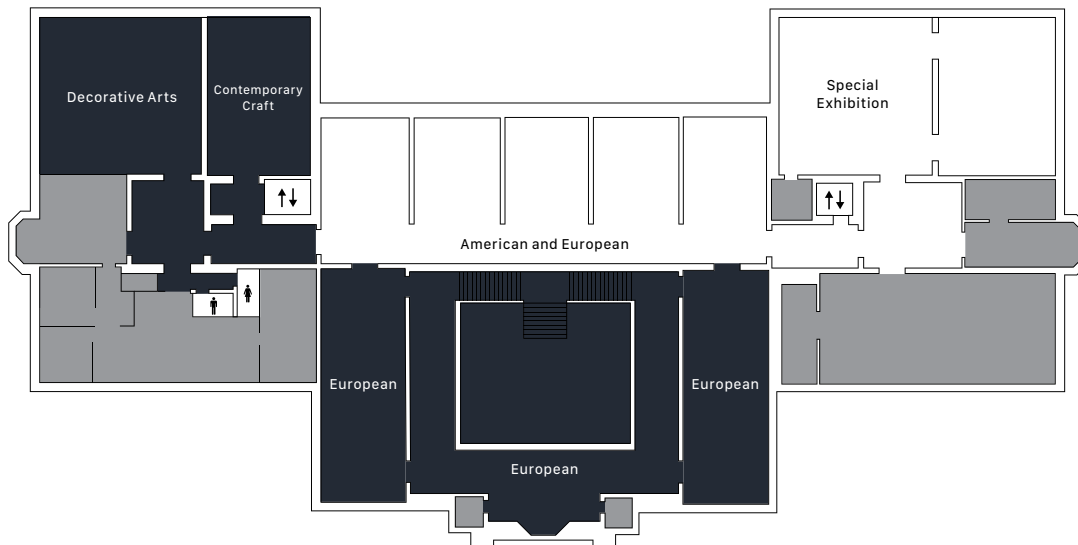

# Spaces that tend to be less-crowded

Lower Level  
*(Second Floor)*

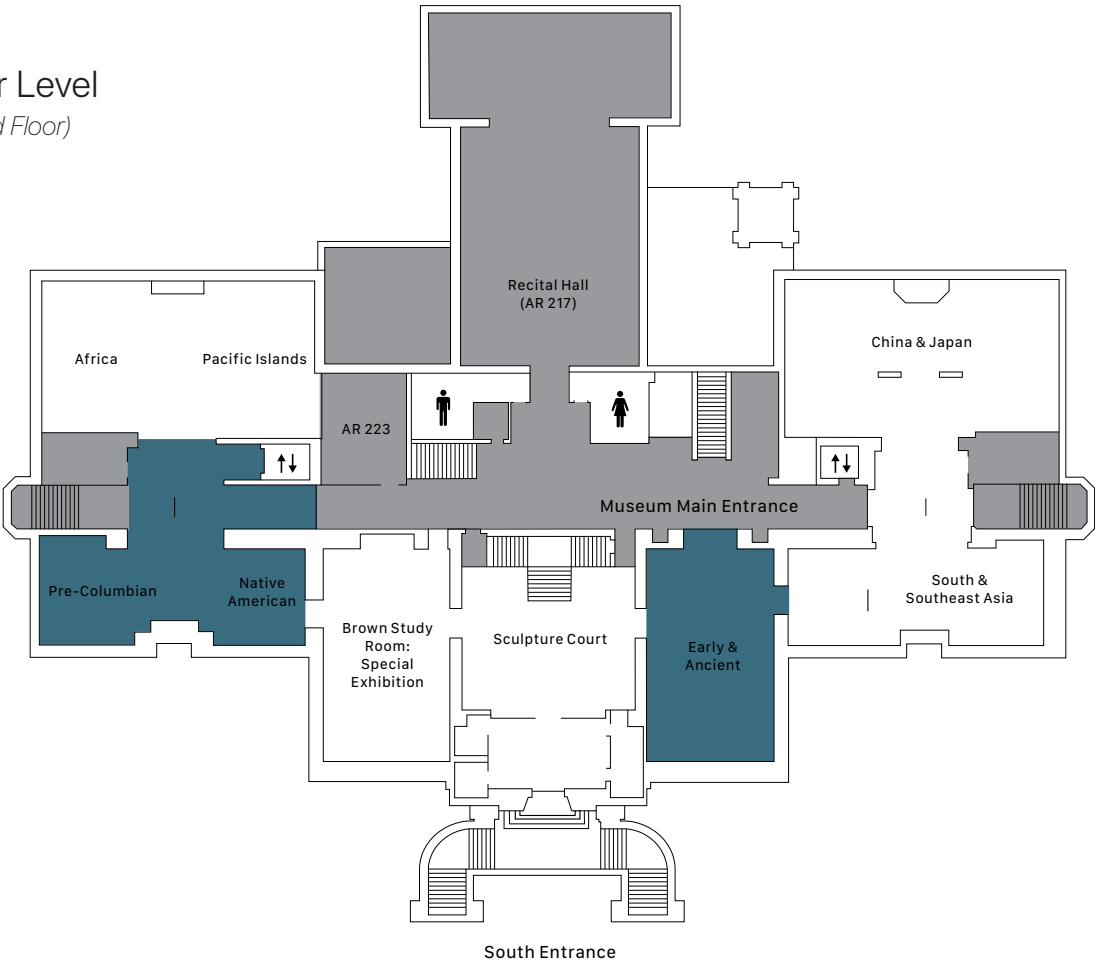

Upper Level  
*(Third Floor)*

